



P1 Push Trolley  
Instruction Manual

(EN)

**REGISTER ONLINE**  
[www.motocaddy.com/warranty](http://www.motocaddy.com/warranty)

## Locating your Serial Number

### Locating your Serial Number

The serial number for the Motocaddy P1 push trolley is located inside the accessory compartment on the handle.

This number is required when registering your warranty online and should be kept handy for future use.

The same number should also be on the box received with your trolley. Please ensure you keep hold of the packaging in case you need to return your trolley for any reason. A proof of purchase must also be kept in case your trolley requires servicing during its warranty period.

**Please keep a record of your trolley serial number here for future reference**

M	C	P	1																
---	---	---	---	--	--	--	--	--	--	--	--	--	--	--	--	--	--	--	--

## Attaching the Wheels / Adjusting the Front Wheel Alignment

### Attaching the Wheels

The Motocaddy P1 has no definitive left or right wheel. To attach the rear wheels, slide the release button down (fig. 1) and slide the wheel axle into the housing.



Fig 1

To attach the front wheel, pull out the release button on the underside of the trolley frame (fig. 2) and slide the front wheel housing into the main frame.

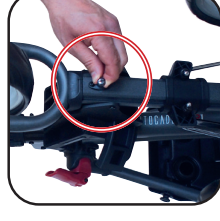

Fig 2

### Adjusting the Front Wheel Alignment

In the unlikely event that your trolley is not tracking in a straight line, the alignment of the front wheel can be adjusted to rectify the fault. This problem can be caused by a number of factors including a slightly loose bag support or an unevenly packed golf bag. Should you wish to alter the alignment of the front wheel you will require a Phillips screwdriver to follow these simple steps:

1. There are two screws on either side of the housing that are used to realign the wheel (fig. 3)
2. If your trolley is veering to the right, turn the left screw counter clockwise and the right screw clockwise
3. If your trolley is veering to the left, turn the right screw counter clockwise and the left screw clockwise

This procedure can be carried out until you are happy the trolley is moving in a straight line (please note you may only need to adjust one screw at a time).

**NB : These instructions are based on positioning yourself in front of the trolley looking at the wheel.**



Fig 3

## Unfolding your Trolley / Adjusting the Handle Height

### Unfolding your Trolley

1. Place the trolley on the floor with all three wheels touching the ground (fig.1)
2. Hold the upper bag support in one hand and the handle in the other. At the same time pull upwards to release the folding lock (fig. 2). You may need to apply a little force to unclip the folding lock
3. Once the folding lock has been released, continue to raise the upper bag support and handle until the central folding catch clicks into position (fig. 3)

**NB : There will be an audible 'click' to indicate the trolley has locked into the unfolded position. It is important to ensure you avoid placing your hand within the folding mechanism during folding and unfolding.**

### Adjusting the Handle Height

To adjust the handle height, release the handle locking lever (fig. 4) and move the handle into the desired position. Resecure the lever once you have selected the required handle height.



Fig 1

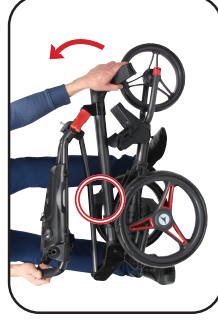

Fig 2



Fig 3



Fig 4

### Folding your Trolley

1. Adjust the handle into the highest position
2. Press the folding button located above the upper bag support (fig. 1) to release the folding catch
3. Hold the upper bag support in one hand and the handle in the other and push both towards the ground (fig. 2)
4. The frame will clip into the folding lock when fully folded (fig. 3)

There should be an audible 'click' to indicate that the folding lock has been engaged. It may be necessary to apply a little downward pressure.

**NB : Always ensure the carry handle is used to lift your trolley when folded (fig. 4). Lifting the trolley in any other position may cause the frame to unfold and could lead to injury.**



Fig 1



Fig 2



Fig 3



Fig 4

## Using the Upper and Lower Bag Supports

### Using the Upper Bag Supports

The upper bag support straps are secured using the following steps:

1. Stretch the elasticated strap around the bag and loop the rounded bar underneath the hook (fig. 1)
2. Position the two placement straps centrally on your golf bag (fig. 2)



Fig 1

### Using the Lower Bag Supports

This Motocaddy trolley is fitted with the EASILOCK™ bag attachment system.

If you are using an EASILOCK™ compatible golf bag please follow these simple instructions:

1. Remove the two pre-fitted lower bag straps by depressing the rear button and sliding (fig. 3)
2. Match up the indicating line on the golf bag with the line on the lower bag support
3. Lower the bag until the pins lock in position. You should hear a small click



Fig 2

If you are using a non-EASILOCK™ golf bag, please use the following instructions:

1. Stretch the elasticated strap around the bag and loop the rounded bar underneath the hook
2. Position the two placement straps centrally on the base of your golf bag

**Please ensure all straps are hooked in place securely before releasing. Failure to do so could result in injury to the user.**

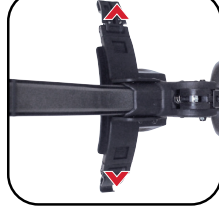

Fig 3

### Adjusting the Bag Supports

The bag support straps are manufactured from elasticated material to allow your golf bag to be held tightly in place.

The strap should be adjusted to be reasonably tight around the golf bag:

1. Unclip the elasticated straps from the housing by pulling outwards in the direction shown (fig. 1)
2. Move the bar as required to tighten or loosen the strap fitting. Pulling the bar downwards will tighten, pushing it upwards will loosen (fig. 2)
3. Ensure that the straps are clipped back into the housing before use

### Using the Parking Brake

To apply or release the foot brake press down on the pedal (fig. 3).

The foot brake is designed to be used as a parking brake (like a hand brake of a car or foot brake on a pram). When applying the brake, please ensure that the trolley has completely stopped moving.

**WARNING: Attempting to apply the brake whilst the trolley is still in motion may cause damage to the trolley and could invalidate the warranty.**

Always ensure that the parking brake has been disengaged before attempting to set off again.

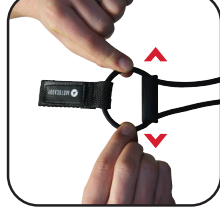

Fig 1



Fig 2



Fig 3



MOTOCADDY®

Motocaddy Ltd, Units 15 - 18 Stansted Distribution Centre,  
Start Hill, Great Hallingbury, Hertfordshire, CM22 7DG, United Kingdom

t: +44 (0)1279 712 370 e: [info@motocaddy.com](mailto:info@motocaddy.com) w: [www.motocaddy.com](http://www.motocaddy.com)



We are dedicated to protecting the environment and encourage the recycling of Motocaddy products through a free collection and disposal service. To find out more or to locate your nearest Motocaddy recycling point, please contact us through our website.

MC.20.45.001

EASILOCK™ Patent (GB) - GB2519073